

Panasonic
ideas for life

NARROW-PITCH CONNECTORS FOR BOARD-TO-BOARD CONNECTION

NARROW PITCH (0.6mm) CONNECTORS P6 SERIES - P6S -



Socket



Header

Compliance with RoHS Directive

FEATURES

1. Bellows-type contacts

Bellows-type contacts resist mating stress and offer high contact reliability.

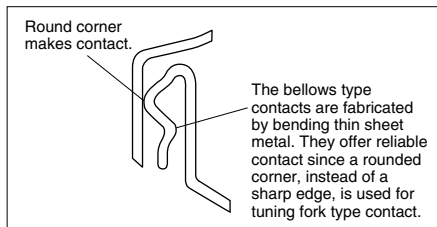

2. Porosity treatment applied for improved resistance against corrosion.

3. Mating length 1.1mm

The effective mating length has been extended to ensure that there is some latitude in the mating.

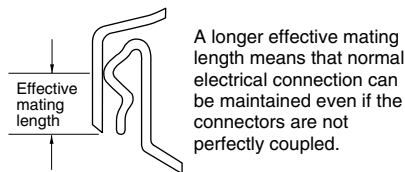

Type	Effective mating length
P6S	1.1mm

4. Automatic mounting

- 1) Suction area for suction-type automatic mounting machines is employed.
- 2) Embossed tape packaging is standard.
- 3) Terminal construction which is virtually resistant to solder bridging.

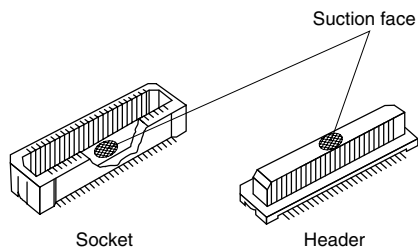

APPLICATIONS

1. Compact portable devices "Cellular phones, DVC, Digital cameras, etc"
2. This is ideal in applications involving information devices such as notebook computers, where connections are required between a backplane and a CPU board or another type of multi-wiring expansion board.

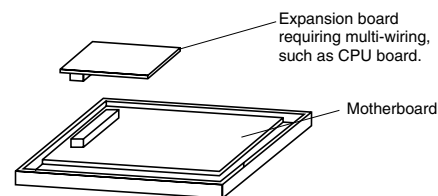

AXK(3/4)S

TABLE OF PRODUCT TYPES

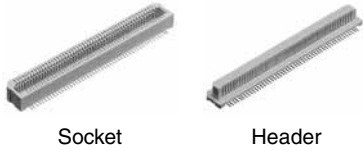

Socket

Header

Mated height	Mated height						
	4.0mm	5.0mm	6.0mm	7.0mm	8.0mm	9.0mm	
Number of contacts	20	☆	☆	☆	☆	☆	☆
	30	☆	☆	☆	☆	☆	☆
	40	☆	☆	☆	☆	☆	☆
	50	☆	☆	☆	☆	☆	☆
	60	☆	☆	☆	☆	☆	☆
	80	☆	☆	☆	☆	☆	☆
	100	☆	☆	☆	☆	☆	☆

- Notes: 1. Special orders are possible for contact numbers not listed in the table above. (Please consult us in such a case.)
 2. The standard type comes with positioning bosses. Connectors without positioning boss are available for on-demand production.

ORDERING INFORMATION

AXK **5** **G**

3S: Narrow Pitch Connector P6S (0.6 mm pitch) Socket
 4S: Narrow Pitch Connector P6S (0.6 mm pitch) Header

Number of contacts (2 digits)

Mated height
 <Socket>

0: For mated height 4.0 mm, 5.0 mm and 6.0 mm
 3: For mated height 7.0 mm, 8.0 mm and 9.0 mm

<Header>

4: For mated height 4.0 mm and 7.0 mm
 5: For mated height 5.0 mm and 8.0 mm
 6: For mated height 6.0 mm and 9.0 mm

Functions

3: With positioning bosses
 4: Without positioning bosses

Surface treatment (Contact portion / Terminal portion)

5: Ni plating on base, Au plating on surface / Ni plating on base, Au plating on surface

Packing

G: Socket for mated height 4.0, 5.0, 6.0 mm and header for mated height 4.0, 7.0 mm:

1,500 pieces embossed tape and plastic reel × 2

Socket for mated height 7.0, 8.0, 9.0 mm and header for mated height 5.0, 6.0, 8.0, 9.0 mm:

1,000 pieces embossed tape and plastic reel × 2

PRODUCT TYPES

Mated height	No. of contacts	Part No.		Packing			
		Socket	Header	Inner carton (1 reel)	Outer carton		
4.0 mm	20	AXK3S20035G	AXK4S20435G	1,500 pieces	3,000 pieces		
	30	AXK3S30035G	AXK4S30435G				
	40	AXK3S40035G	AXK4S40435G				
	50	AXK3S50035G	AXK4S50435G				
	60	AXK3S60035G	AXK4S60435G				
	80	AXK3S80035G	AXK4S80435G				
5.0 mm	100	AXK3S00035G	AXK4S00435G	Socket: 1,500 pieces Header: 1,000 pieces	Socket: 3,000 pieces Header: 2,000 pieces		
	20	AXK3S20035G	AXK4S20535G				
	30	AXK3S30035G	AXK4S30535G				
	40	AXK3S40035G	AXK4S40535G				
	50	AXK3S50035G	AXK4S50535G				
	60	AXK3S60035G	AXK4S60535G				
6.0 mm	80	AXK3S80035G	AXK4S80535G			Socket: 1,000 pieces Header: 1,500 pieces	Socket: 2,000 pieces Header: 3,000 pieces
	100	AXK3S00035G	AXK4S00635G				
	20	AXK3S20035G	AXK4S20635G				
	30	AXK3S30035G	AXK4S30635G				
	40	AXK3S40035G	AXK4S40635G				
	50	AXK3S50035G	AXK4S50635G				
7.0 mm	60	AXK3S60035G	AXK4S60635G	1,000 pieces	2,000 pieces		
	80	AXK3S80035G	AXK4S80635G				
	100	AXK3S00035G	AXK4S00635G				
	20	AXK3S20335G	AXK4S20435G				
	30	AXK3S30335G	AXK4S30435G				
	40	AXK3S40335G	AXK4S40435G				
8.0 mm	50	AXK3S50335G	AXK4S50435G	1,000 pieces	2,000 pieces		
	60	AXK3S60335G	AXK4S60535G				
	80	AXK3S80335G	AXK4S80535G				
	100	AXK3S00335G	AXK4S00535G				
	20	AXK3S20335G	AXK4S20535G				
	30	AXK3S30335G	AXK4S30535G				
9.0 mm	40	AXK3S40335G	AXK4S40535G	1,000 pieces	2,000 pieces		
	50	AXK3S50335G	AXK4S50535G				
	60	AXK3S60335G	AXK4S60635G				
	80	AXK3S80335G	AXK4S80635G				
	100	AXK3S00335G	AXK4S00635G				
	20	AXK3S20335G	AXK4S20635G				

- Notes) 1. Regarding ordering units: During production: Please make orders in 1 reel units.
 Samples for mounting confirmation: Available in units of 50 pieces. Please consult us. (See "Regarding sample orders to confirm proper mounting" on page 19.)
 Samples: Small lot orders are possible.
2. The standard type comes without positioning bosses. Connectors with positioning bosses are available for on-demand production.
 For this type of connector, 9th digit of the part no. changes from 3 to 4 e.g. Mated height 4.0 mm, 20 contacts for sockets: AXK3S20045G.

SPECIFICATIONS

1. Characteristics

Item	Specifications		Conditions
	Mated height: 4.0mm, 5.0mm, 6.0mm, 7.0mm, 8.0mm, 9.0mm		
Electrical characteristics	Rated current	0.5A/terminal (Max. 16 A)	
	Rated voltage	60V AC/DC	
	Breakdown voltage	150V AC for 1 min.	Detection current: 1mA
	Insulation resistance	Min. 1,000MΩ	Using 500V DC megger
	Contact resistance	Max. 80mΩ	Based on the contact resistance measurement method specified by JIS C 5402.
Mechanical characteristics	Composite insertion force	Max. 0.785N {80gf} × no. of contacts (initial)	
	Composite removal force	Min. 0.0588N {6gf} × no. of contacts	
	Post holding force	Min. 0.98N {100gf}	Measures the maximum load in the post axial direction until removal
Environmental characteristics	Ambient temperature	-55°C to +85°C	No freezing at low temperatures
	Soldering heat resistance	Max. peak temperature of 245°C (on the surface of the PC board around the connector terminals)	Infrared reflow soldering
		300°C within 5 sec.	Soldering iron
	Thermal shock resistance (header and socket mated)	5 cycles, insulation resistance min. 100MΩ, contact resistance max. 80mΩ	Sequence 1. -55 ⁻³ °C, 30 minutes 2. ~, Max. 5 minutes 3. 85 ⁺³ °C, 30 minutes 4. ~, Max. 5 minutes
	Humidity resistance (header and socket mated)	120 hours, insulation resistance min. 100MΩ, contact resistance max. 80mΩ	Bath temperature 40±2°C, humidity 90 to 95% R.H.
	Saltwater spray resistance (header and socket mated)	24 hours, insulation resistance min. 100MΩ, contact resistance max. 80mΩ	Bath temperature 35±2°C, saltwater concentration 5±1%
Lifetime characteristics	H ₂ S resistance (header and socket mated)	48 hours, contact resistance max. 80mΩ	Bath temperature 40±2°C, gas concentration 3±1 ppm, humidity 75 to 80% R.H.
	Insertion and removal life	50 times	Repeated insertion and removal speed of max. 200 times/hours
Unit weight	P6S Mated height: 4mm 50 contacts; Socket: 0.29g Header: 0.26g		

2. Material and surface treatment

Part name	Mated height: 4.0mm, 5.0mm, 6.0mm, 7.0mm, 8.0mm, 9.0mm	
	Material	Surface treatment
Molded portion	Heat-resistant resin (UL94V-0)	—
Contact/post	Copper alloy	Contact portion: Ni plating on base, Au plating on surface Terminal portion: Ni plating on base, Au plating on surface (Except for thick of terminal)

DIMENSIONS (Unit: mm)

The CAD data of the products with a **CAD Data** mark can be downloaded from: <http://www.mew.co.jp/ac/e>

- Mated height: 4.0mm, 5.0mm, 6.0mm, 7.0mm, 8.0mm, 9.0mm

- **Socket**

CAD Data

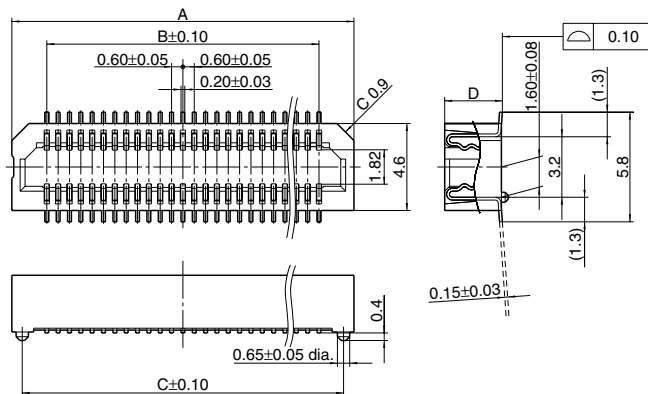

Recommended PC board pattern (TOP VIEW)

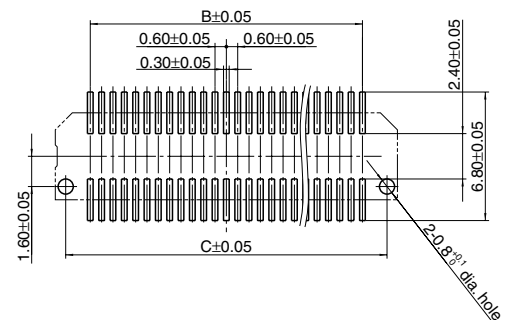

General tolerance: ±0.2

Dimension table (mm)

No. of contact	A	B	C
20	9.1	5.40	8.00
30	12.1	8.40	11.00
40	15.1	11.40	14.00
50	18.1	14.40	17.00
60	21.1	17.40	20.00
80	27.1	23.40	26.00
100	33.1	29.40	32.00

Mated height	D
4.0mm, 5.0mm, 6.0mm	3.05
7.0mm, 8.0mm, 9.0mm	6.05

The specifications and appearance of this product are subject to change for improvement. Please contact us for details.

• Header

CAD Data

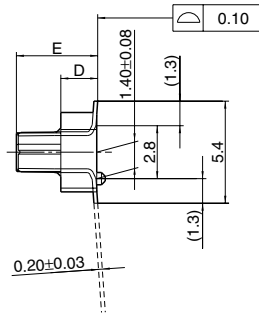
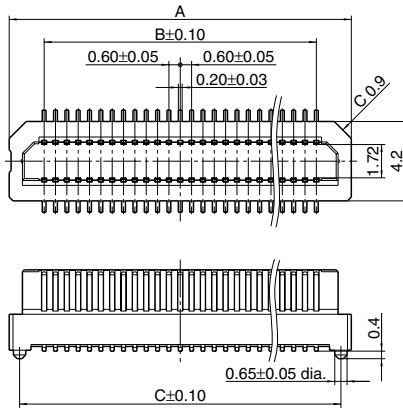

Recommended PC board pattern (TOP VIEW)

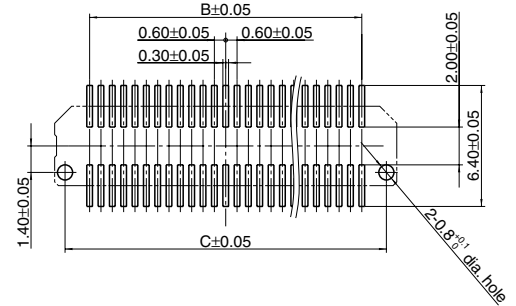

General tolerance: ±0.2

Dimension table (mm)

No. of contact	A	B	C
20	9.1	5.40	8.00
30	12.1	8.40	11.00
40	15.1	11.40	14.00
50	18.1	14.40	17.00
60	21.1	17.40	20.00
80	27.1	23.40	26.00
100	33.1	29.40	32.00

Mated height	D	E
4.0mm, 7.0mm	0.95	3.3
5.0mm, 8.0mm	1.95	4.3
6.0mm, 9.0mm	2.95	5.3

Socket and header are mated

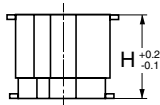

Mated height	H
4.0mm	4
5.0mm	5
6.0mm	6
7.0mm	7
8.0mm	8
9.0mm	9

EMBOSSED TAPE DIMENSIONS (unit: mm, Common for respective contact type, socket and header)

• Tape dimensions (Conforming to JIS C 0806-1990. However, some tapes have mounting hole pitches that do not comply with the standard.)

• Plastic reel dimensions (Conforming to EIAJ ET-7200B)

Tape I

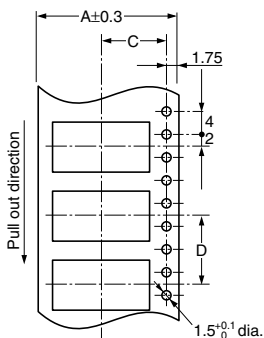

Tape II

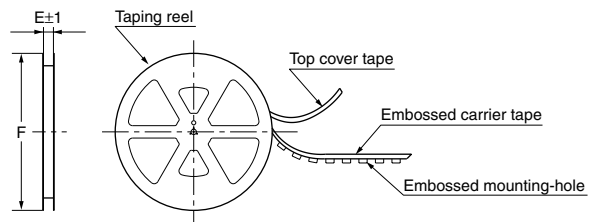
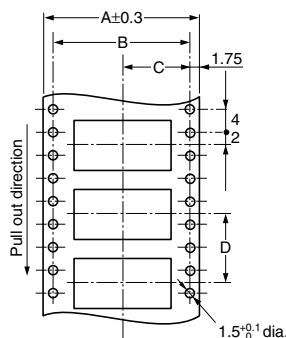

The specifications and appearance of this product are subject to change for improvement. Please contact us for details.

Dimension table (mm)

Suffix: G (embossed tape package)

Mated height	No. of contacts	Type of taping	A	B	C	D	E	F	Quantity per reel
Socket: 4.0mm, 5.0mm, 6.0mm	20 to 40	Tape I	24.0	—	11.5	12.0	25.4±1	380 dia.	1,500
	50 to 60	Tape II	32.0	28.4	14.2	12.0	33.4±1		
	80	Tape II	44.0	40.4	20.2	12.0	45.4±1		
	100	Tape II	56.0	52.4	26.2	12.0	57.4±1		
Socket: 7.0mm, 8.0mm, 9.0mm	20 to 40	Tape I	24.0	—	11.5	12.0	25.4±1	380 dia.	1,000
	50 to 60	Tape II	32.0	28.4	14.2	12.0	33.4±1		
	80	Tape II	44.0	40.4	20.2	12.0	45.4±1		
	100	Tape II	56.0	52.4	26.2	12.0	57.4±1		
Header: 4.0mm, 7.0mm	20 to 40	Tape I	24.0	—	11.5	12.0	25.4±1	380 dia.	1,500
	50	Tape II	32.0	28.4	14.2	12.0	33.4±1		
	60 to 80	Tape II	44.0	40.4	20.2	12.0	45.4±1		
	100	Tape II	56.0	52.4	26.2	12.0	57.4±1		
Header: 5.0mm, 6.0mm, 8.0mm, 9.0mm	20 to 40	Tape I	24.0	—	11.5	12.0	25.4±1	380 dia.	1,000
	50 to 60	Tape II	32.0	28.4	14.2	12.0	33.4±1		
	80	Tape II	44.0	40.4	20.2	12.0	45.4±1		
	100	Tape II	56.0	52.4	26.2	12.0	57.4±1		

Connector orientation with respect to direction of progress of embossed tape

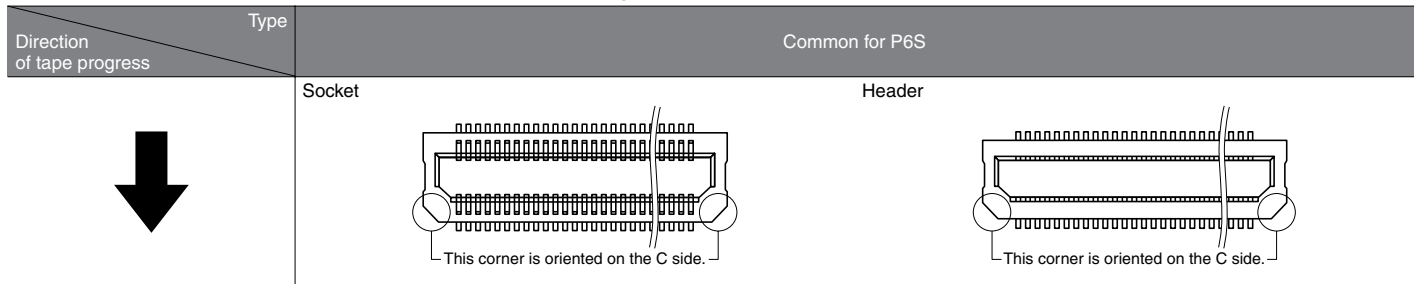

NOTES

1. Prevention of reverse mating

Excessive mating force may damage the key, so be sure to match chamfered corners when mating.

For other details, please verify with the product specification sheets.

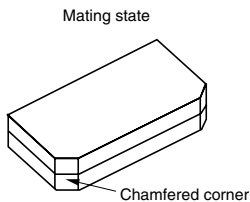
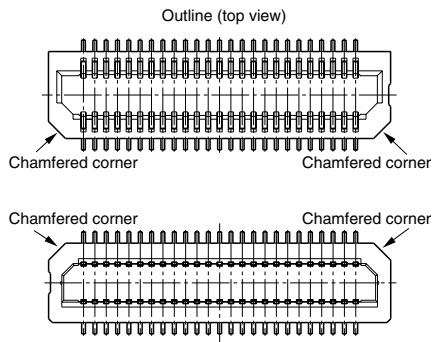

The specifications and appearance of this product are subject to change for improvement. Please contact us for details.